



- LEGEND:**
- OVERALL PROJECT BOUNDARY
 - ▭ PROPOSED BUILDINGS
 - PROPOSED PRIVATE ROAD
 - SWM PROPOSED STORMWATER MANAGEMENT BASIN
 - 16 PROPOSED GOLF GREEN AND FAIRWAY

OPEN SPACE CALCULATION

NATURAL WOODLANDS/WETLANDS	
OPEN SPACE 1	224.7 ACRES
OPEN SPACE 2	41.0 ACRES
OPEN SPACE 3	6.1 ACRES
OPEN SPACE 4	1.9 ACRES
OPEN SPACE 5	2.8 ACRES
OPEN SPACE 6	42.0 ACRES
SUBTOTAL:	318.5 ACRES

FIELDS / MEADOWS / RE-VEGETATED OPEN SPACE	
OPEN SPACE 7	8.2 ACRES
OPEN SPACE 8	3.7 ACRES
OPEN SPACE 9	30.7 ACRES
SUBTOTAL:	42.6 ACRES

GOLF OPEN SPACE	
OPEN SPACE 10	88.2 ACRES
OPEN SPACE 11	85.0 ACRES
OPEN SPACE 12	2.3 ACRES
SUBTOTAL:	175.5 ACRES

TOTAL: 536.6 ACRES

PARCEL ACREAGE = 670.7 +/- ACRES
OPEN SPACE = 536.6 +/- ACRES
OPEN SPACE % = 80.0%

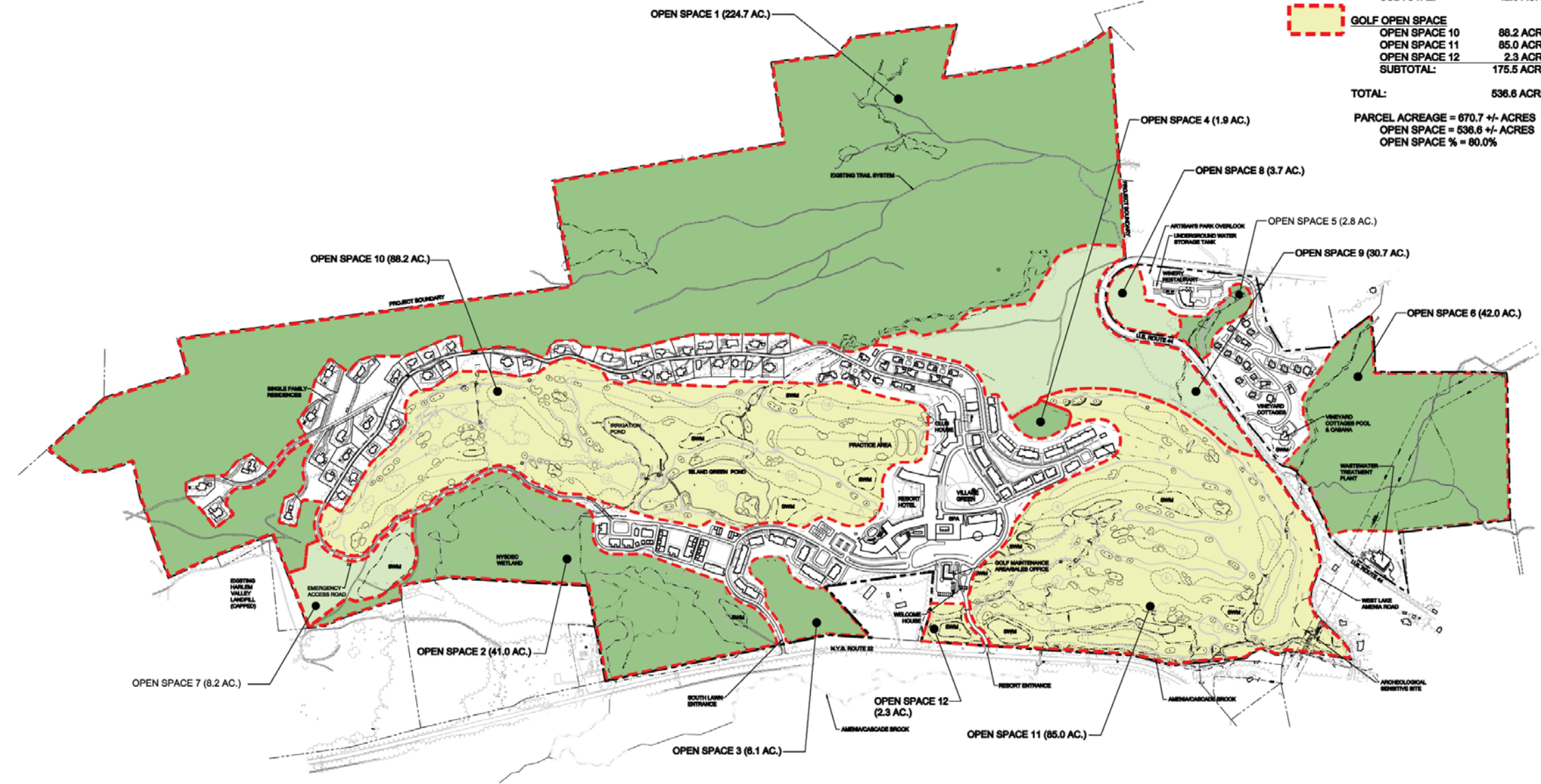

ARCHITECT OF RECORD - RESORT

Jf Jensen Fey
 PHONE: 425.216.0318 FAX: 425.216.0329
 7730 Leary Way, Redmond, WA 98052

ARCHITECT OF RECORD - RESIDENTIAL

MINNO & WASKO
 ARCHITECTS AND PLANNERS
 1000 UNIVERSITY AVENUE, SUITE 100
 SEASIDE, CA 94065
 TEL: 415.947.1100 FAX: 415.947.1101

SURVEY, PLANNING AND ENGINEERING

CHAZEN ENGINEERING, LAND SURVEYING
 LANDSCAPE ARCHITECTURE CO., P.C.

GOLF COURSE ARCHITECT

ERNIE ELS DESIGN
 1000 UNIVERSITY AVENUE, SUITE 100
 SEASIDE, CA 94065
 TEL: 415.947.1100 FAX: 415.947.1101

NATURAL RESOURCE MANAGEMENT PLAN

AUDUBON INTERNATIONAL
 1000 UNIVERSITY AVENUE, SUITE 100
 SEASIDE, CA 94065
 TEL: 415.947.1100 FAX: 415.947.1101

WATER AND WASTEWATER TREATMENT FACILITIES

DELAWARE OPERATIONS, INC.
 1000 UNIVERSITY AVENUE, SUITE 100
 SEASIDE, CA 94065
 TEL: 415.947.1100 FAX: 415.947.1101

NOTES:

No.	ISSUE	DATE
4	MASTER DEVELOPMENT PLAN FOR SPECIAL USE PERMIT	03-20-09
3	MASTER DEVELOPMENT PLAN FOR SPECIAL USE PERMIT	01-09-09
2	REC-ISSUE MASTER DEVELOPMENT PLAN	09-16-08
1	MASTER DEVELOPMENT PLAN	04-03-08

KEY PLAN

SILO RIDGE RESORT COMMUNITY
 AMENIA, NY

ROBERT A.M. STERN ARCHITECTS, LLP
 480 WEST 54th STREET, NEW YORK, NY 10019
 TEL: (212) 967-5100 • FAX: (212) 967-5600

HIGHER GROUND COUNTRY CLUB MANAGEMENT CO., LLC
 510 WOOD COUNTRY CLUB
 P.O. BOX 88
 AMENIA, NY 12501

OPEN SPACE PLAN

Project No.	10454.02	Date	04/03/08
CAD File No.		Scale	1"=300'
Drawing No.			

SP-5