

## **APPENDIX D: WATER RESOURCES**

### **D.5 Buffer Management Comparison Plans**

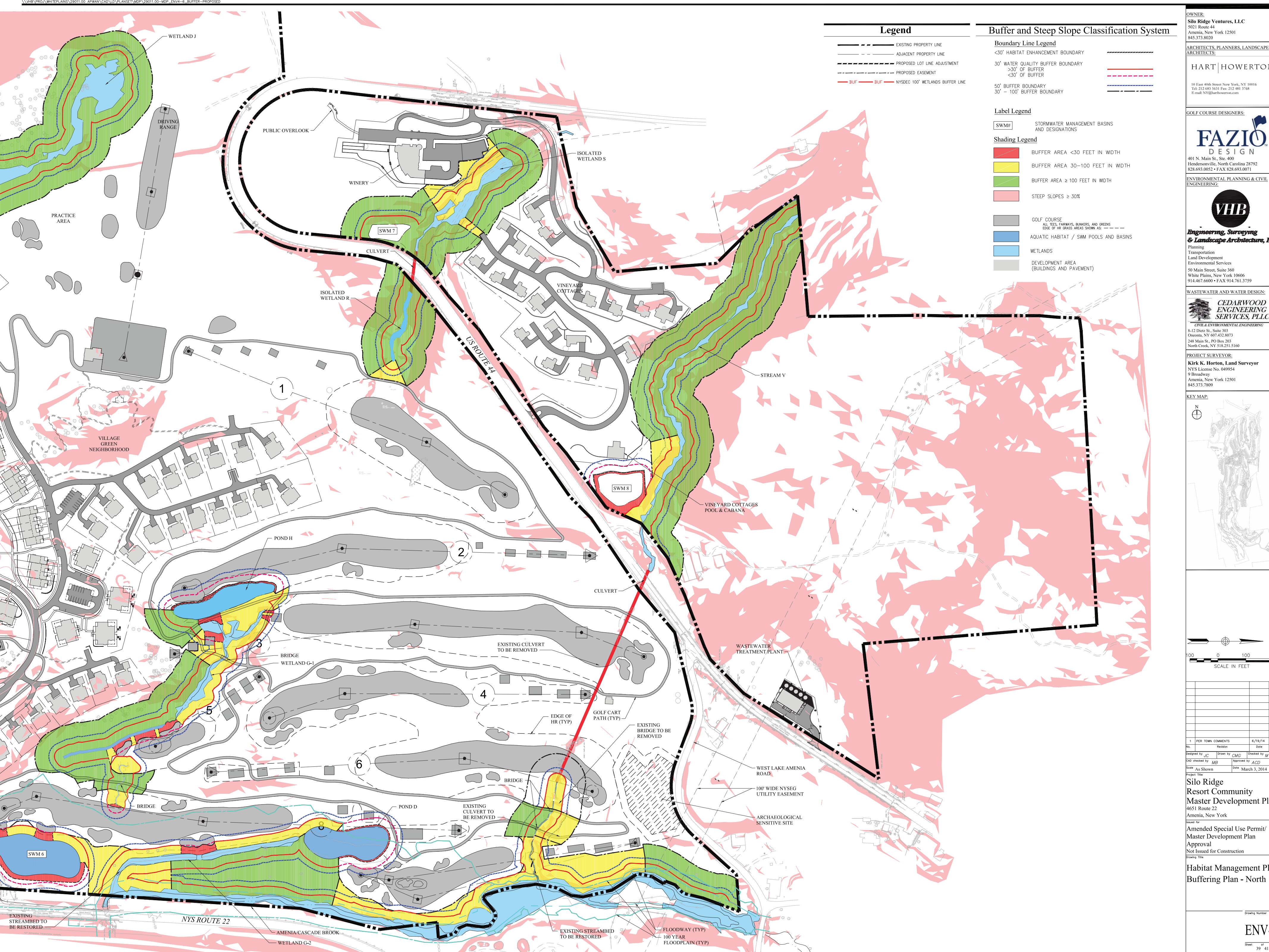



## EXISTING NATURAL HABITATS -

NOTES:

1. Linear aquatic edge for ponds/SWM is measured by the shoreline distance of waterbody. Linear edge habitat for wetlands is determined using the delineated line distance of the wetland. Stream linear edge habitat is calculated according to the linear distance along the top of each bank (2banks) of stream bed. Current and (Proposed) edge habitat distances vary in some instances due to expansion of existing ponds or day-lighting of stream channels for the redesigned golf course (see Figures ENV-4,5,6 for additional detail).

2. The current buffered area represents site conditions and on-site vegetative buffers, in excess of 30 feet in width, presently adjacent to sensitive habitats at the Silo Ridge Site as of August 2008.

3. The proposed buffered area represents all conservation and water quality buffers identified in the Habitat Management Plan in excess of 30 foot in width. When appropriate, percent buffered calculations include the expanded habitat distances identified for total aquatic edge.

4. Amenita Brook includes Wetland C-1, Wetland C-2, and Wetland C-3

**Water Quality Buffer (30 feet in width) Coverage**  
**Constructed Habitats**

NOTES

1. Linear aquatic edge for ponds/SWM is measured by the shoreline distance of waterbody. Linear edge habitat for wetlands is determined using the delineated line distance of the wetland. Stream linear edge habitat is calculated according to the linear distance along the top of each bank (2banks) of stream bed. Current and (Proposed) edge habitat distances vary in some instances due to expansion of existing ponds or day-lighting of stream channels for the redesigned golf course (see Figures ENV-4,5,6 for additional detail).

2. The current buffered area represents site conditions and on-site vegetative buffers, in excess of 30 feet in width, presently adjacent to sensitive habitats at the Silo Ridge Site as of August 2008.

3. The proposed buffered area represents all conservation and water quality buffers identified in the Habitat Management Plan in excess of 30 foot in width. When appropriate, percent buffered calculations include the expanded habitat distances identified for total aquatic edge.

4. The reduction of the aquatic edges for Ponds K and Z is due to the removal of the green island at the northern edge for Pond Z, as well as the connection of Pond K with Pond Z.

DRAWING #:  
BC-1



## PROPOSED BUFFER PLAN

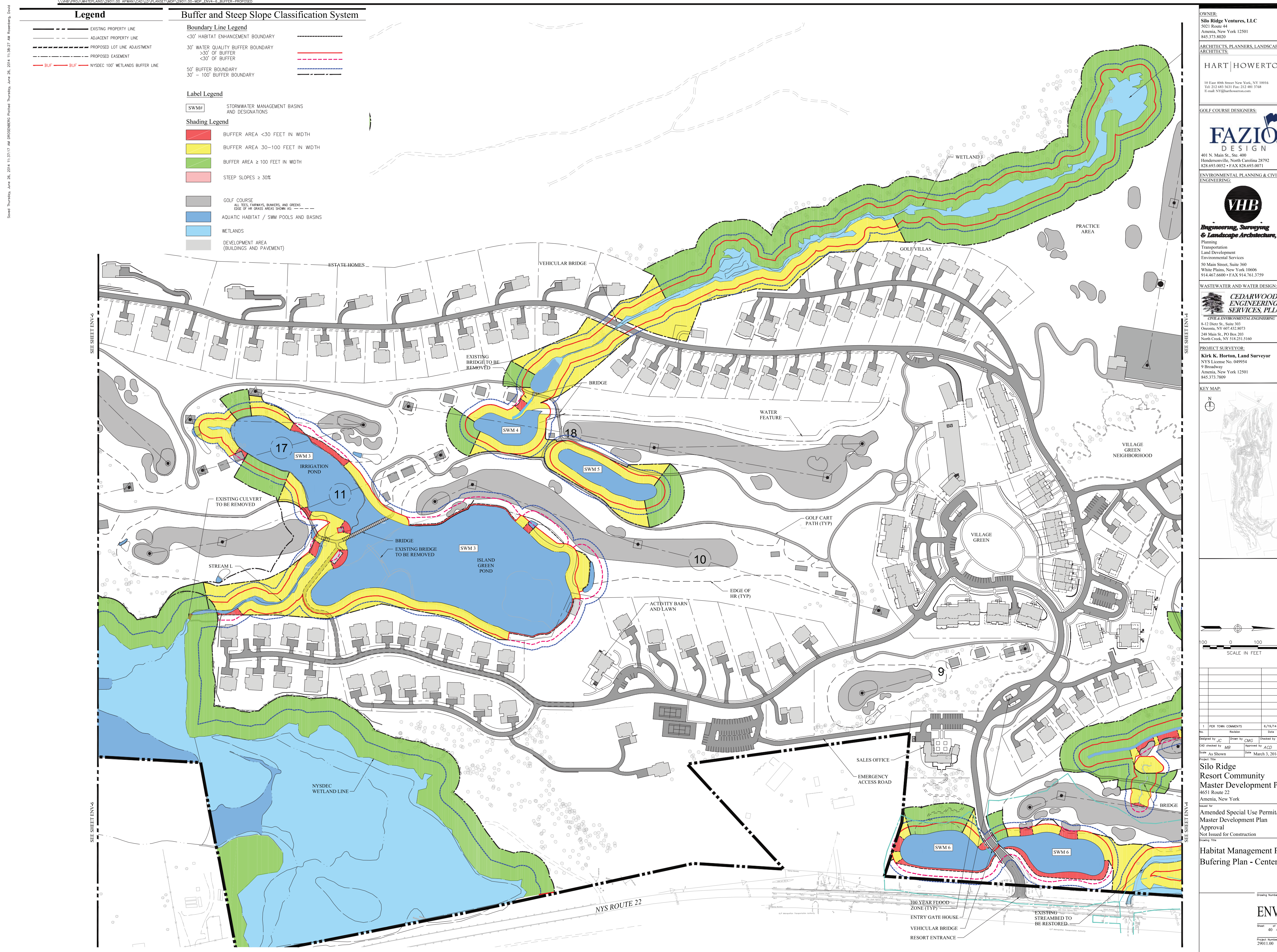

## EXISTING NATURAL HABITATS -

## NOTES

1. Linear aquatic edge for ponds/SWM is measured as the shoreline distance of waterbody. Linear edge habitat for wetlands is determined using the delineated line distance of the wetland. Stream linear edge habitat is calculated according to the linear distance along the top of each bank (2banks) of stream bed. Current and (Proposed) edge habitat distances vary in some instances due to expansion of existing ponds or day-lighting of stream channels for the redesigned golf course (see Figures EN-V-4,5,6 for additional detail).
2. The current buffered area represents site conditions and on-site vegetative buffers, in excess of 30 feet in width, presently adjacent to sensitive habitats at the Silo Ridge Site as of August 2008.
3. The proposed buffered area represents all conservation and water quality buffers identified in the Habitat Management Plan in excess of 30 foot in width. When appropriate, percent buffered calculations include the expanded habitat distances identified for total aquatic edge.
4. Armenia Brook includes Wetland C-1, Wetland C-2, and Wetland C-3

**Water Quality Buffer (30 feet in width) Coverage**  
**Constructed Habitats**

## NOTES

1. Linear aquatic edge for ponds/SWM is measured as the shoreline distance of waterbody. Linear edge habitat for wetlands is determined using the delineated line distance of the wetland. Stream linear edge habitat is calculated according to the linear distance along the top of each bank (2banks) of stream bed. Current and (Proposed) edge habitat distances vary in some instances due to expansion of existing ponds or day-lighting of stream channels for the redesigned golf course (see Figures ENV-4,5,6 for additional detail).
2. The current buffered area represents site conditions and on-site vegetative buffers, in excess of 30 feet in width, presently adjacent to sensitive habitats at the Silo Ridge Site as of August 2008.
3. The proposed buffered area represents all conservation and water quality buffers identified in the Habitat Management Plan in excess of 30 foot in width. When appropriate, percent buffered calculations include the expanded habitat distances identified for total aquatic edge.
4. The reduction of the aquatic edges for Ponds K and Z is due to the removal of the green island at the northern edge for Pond Z, as well as the connection of Pond K with Pond Z.

DATE:  
AUGUST 20TH, 2014

DRAWING #:  
BC-2



# PROPOSED BUFFER PLAN



## EXISTING NATURAL HABITATS -

### Natural Sensitive Habitats

NOTES:

- Linear aquatic edge for ponds/SWM is measured by the shoreline distance of waterbody. Linear edge habitat for wetlands is determined using the delineated line distance of the wetland. Stream linear edge habitat is calculated according to the linear distance along the top of each bank (2banks) of stream bed. Current and (Proposed) edge habitat distances vary in some instances due to expansion of existing ponds and day-lighting of stream channels for the redesigned golf course (see Figures ENV-4,5,6 for additional detail).
- The current buffered area represents site conditions and on-site vegetative buffers, in excess of 30 feet in width, presently adjacent to sensitive habitats at the Silo Ridge Site as of August 2008.
- The proposed buffered area represents all conservation and water quality buffers identified in the Habitat Management Plan in excess of 30 foot in width. When appropriate, percent buffered calculations include the expanded habitat distances identified for total aquatic edge.
- Amenia Brook includes Wetland C-1, Wetland C-2, and Wetland C-3

## CONSTRUCTED HABITATS -

### Constructed Habitats

Linear aquatic edge for ponds/SWM is measured by the shoreline distance of waterbody. Linear edge habitat for wetlands is determined using the delineated line distance of the wetland. Stream linear edge habitat is calculated according to the linear distance along the top of each bank (2banks) of stream bed. Current and (Proposed) edge habitat distances vary in some instances due to expansion of existing ponds or day-lighting of stream channels for the redesigned golf course (see Figures ENV-4,5,6 for additional detail).

The current buffered area represents site conditions and on-site vegetative buffers, in excess of 30 feet in width, presently adjacent to sensitive habitats at the Silo Ridge Site as of August 2008.

The proposed buffered area represents all conservation and water quality buffers identified in the Habitat Management Plan in excess of 30 foot in width. When appropriate, percent buffered calculations include the expanded habitat distances identified for total aquatic edge.

The reduction of the aquatic edges for Ponds K and Z is due to the removal of the green island at the northern edge for Pond Z, as well as the connection of Pond K with Pond Z.

DATE:  
AUGUST 20TH, 2014

DRAWING #:  
BC-3